

SECCIÓ 1-1 VIAL APARCAMENT

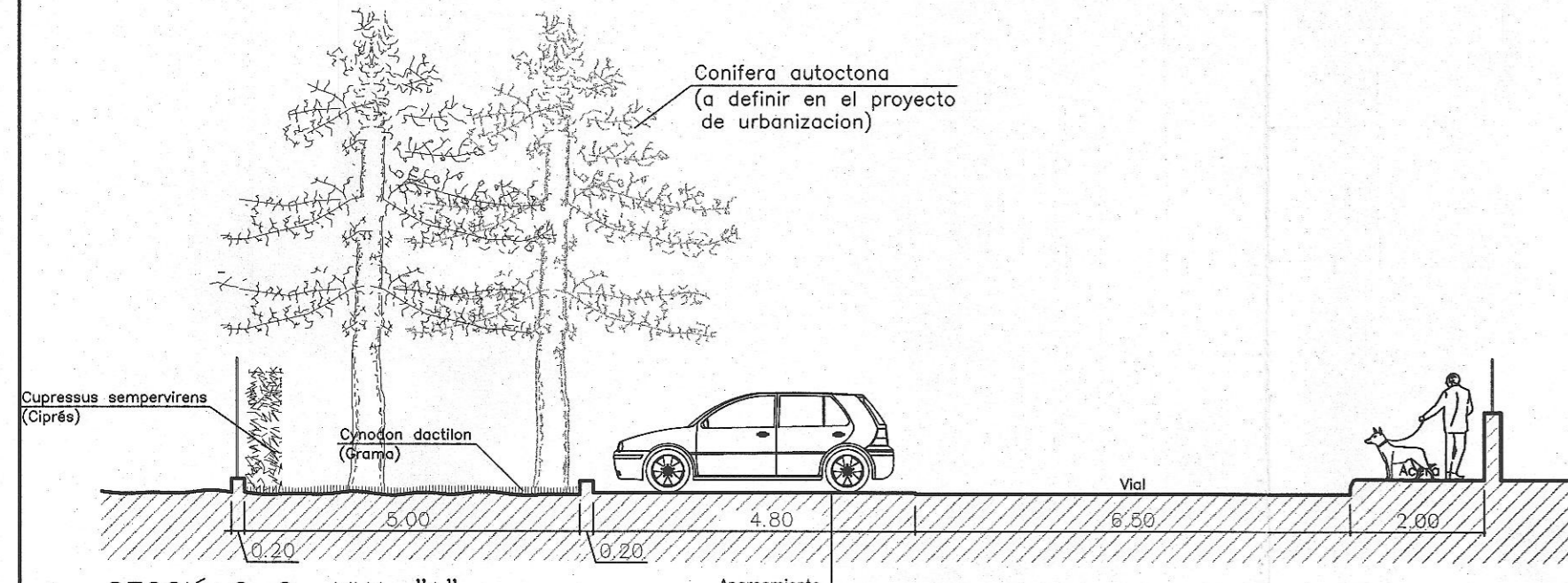

SECCIÓ 2-2 VIAL "A"

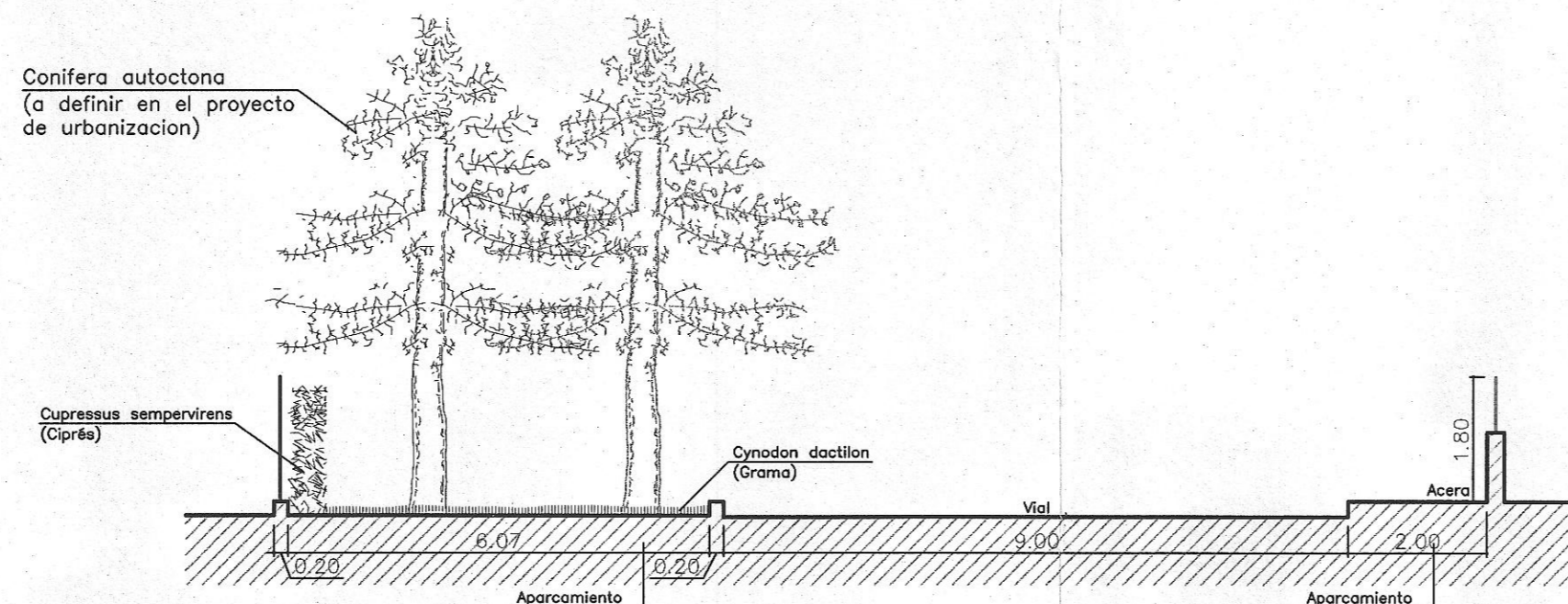

SECCIÓ 4-4 VIAL "K"

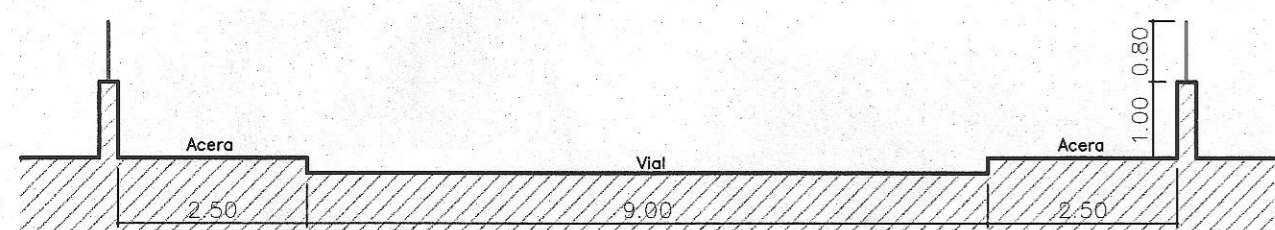

SECCIÓ 3-3 VIAL "K"

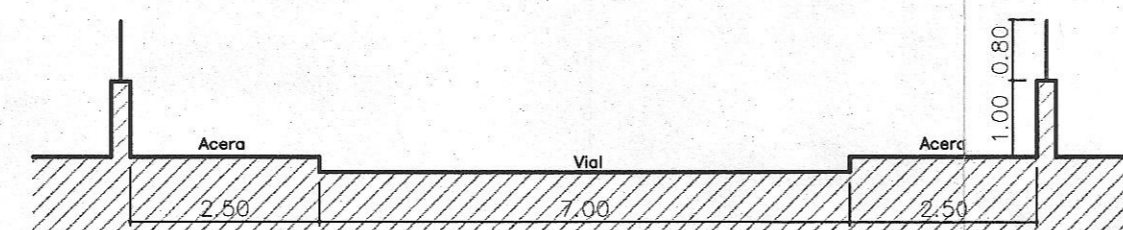

SECCIÓ 5-5 VIAL "A", "B", "F", "G"

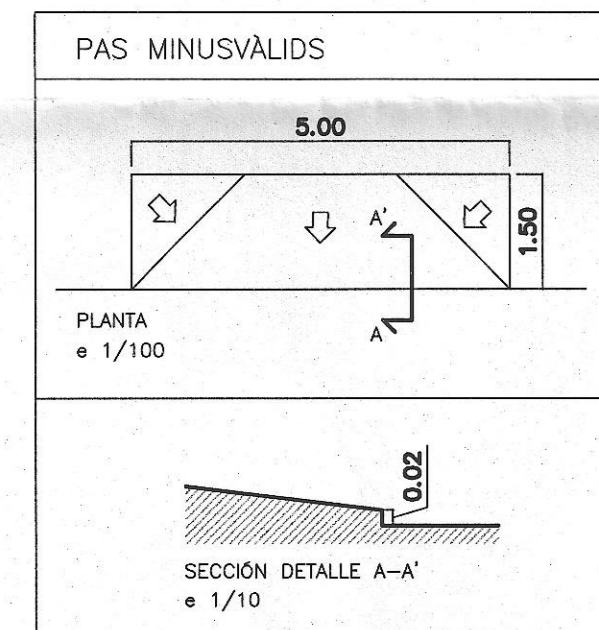

Ⓟ APARCAMENTS = 603
 ♿ APARCAMENTS MINUSVALIDS = 19

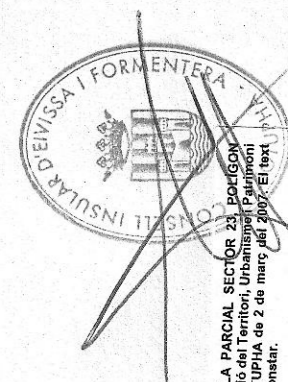
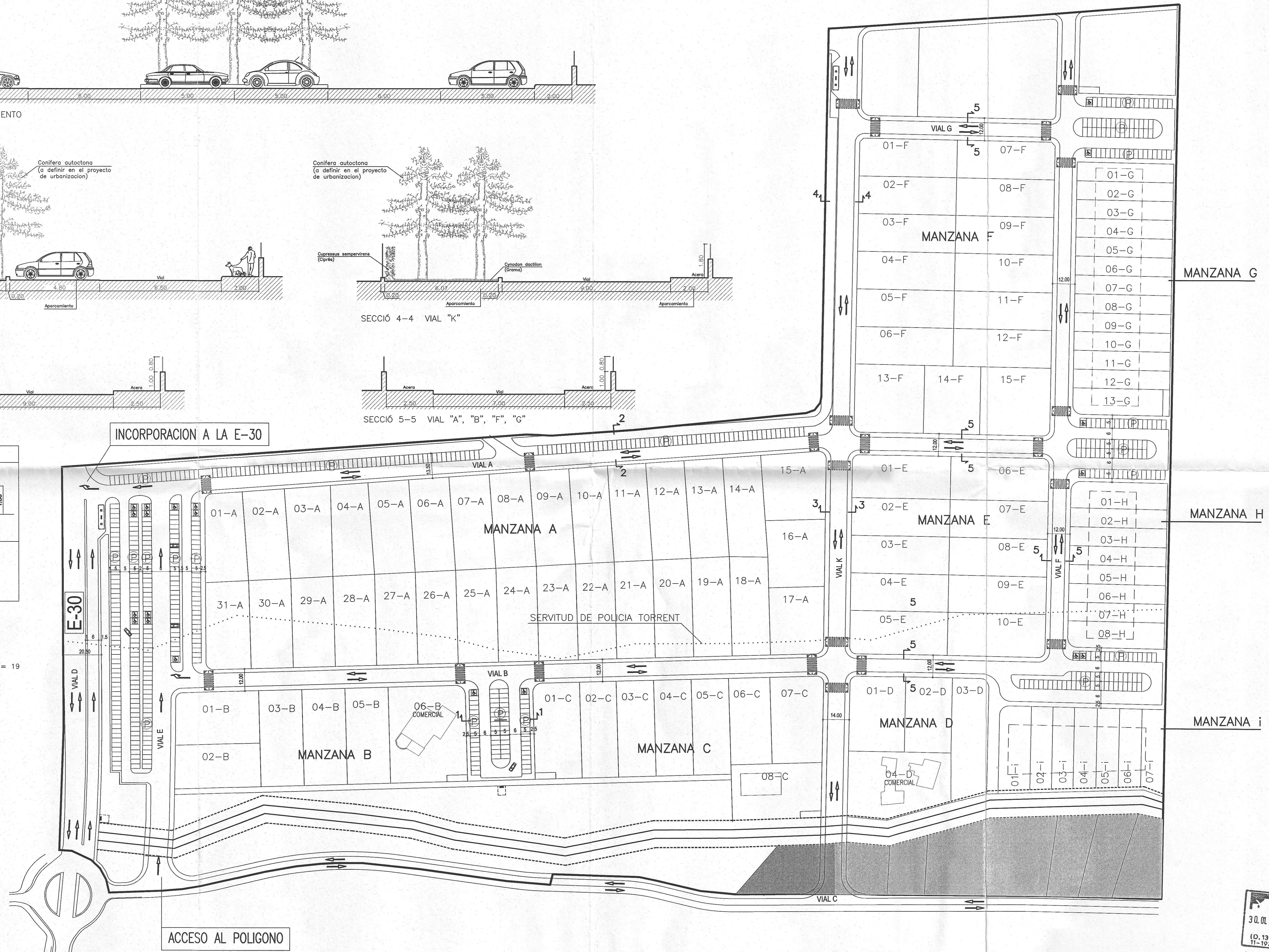
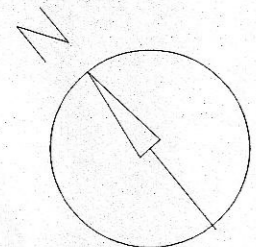

COLLEGI OFICIAL D'ARQUITECTES ILLES BALEARS
 30.01.073/0279/07
 SEGELLAT
 (D.13-6-1931, LLEI 4-11-1931, O.9-5-1940)

000226